



DESCRIPTION

1007WFC

Brass union F x F cone BS5200 60°. With O-Ring.
Yellow.

Compatible with all Pettinaroli Euro-cone and BS5200 60° connections.

DIMENSIONS

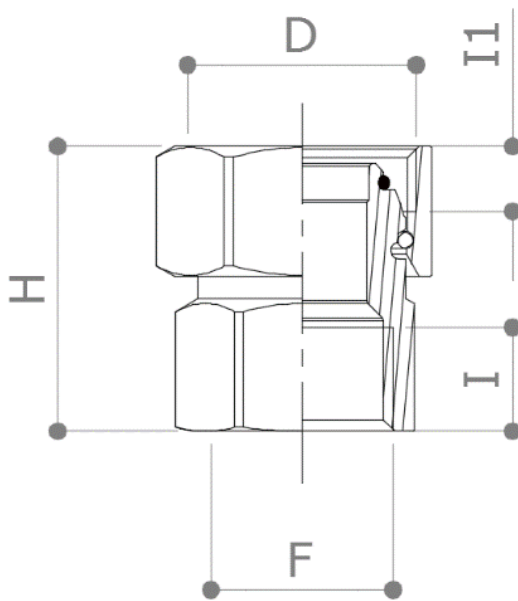

| | | |
|------------|------|------|
| D | 3/4" | 3/4" |
| F | 1/2" | 3/4" |
| H | 33 | 38.5 |
| I | 13.5 | 15.5 |
| I1 | 7.5 | 7.5 |
| Weight [g] | 95 | 130 |

Dimensions in mm

All threads are conform to ISO 228 standard

MATERIALS

Body CW617N (EN 12165) CuZn40Pb2

Nut CW617N (EN 12165) CuZn40Pb2

O-Ring EPDM

RECOMMENDED WORKING TEMPERATURE/PRESSURE LIMIT

30 bar – 100°C – non shock

Max closing torque: 40 Nm (cone 60° BS5200)