

DESCRIPTION

**083IHV**

Insulating cases for PICV 83 series DN40 and DN50.

Sandwich structure:

- external layer made by high density insulating material to make it hard;
- internal layer made by low density insulating material with high insulation performance.

Made by 2 shells with Velcro®.

MATERIALS

Body (external layer)

Polyethylene cross linked foam, density 80 kg/m<sup>3</sup>

Body (internal layer)

Polyethylene cross linked foam, density 29 kg/m<sup>3</sup>

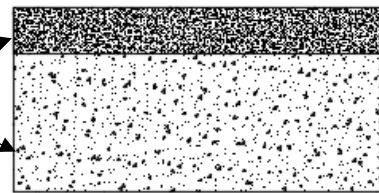

TECHNICALS CHARACTERISTICS OF INSULATION

	Standard	Insulation case	
Density [Kg/m <sup>3</sup> ]	ISO 845	29	80
Compression stress (50% deflection) [kPa]	ISO 3386/1	88	260
Tensile strength longitudinal [Mpa]	ISO 1798	0.18	0.8
Extension longitudinal stretch [%]	ISO 1798	120 (at break)	170 (at break)
Residual distortion 22 h at 23°C [%] Deflection of 25% 24h after release	ISO 1856	13	1.5
Operating temperature range [°C]	-	-60/+90	-60/+90
Thermal conductivity [W/mK]	EN 12667	0.040	0.049
Fire resistance rating		1 – UNI9177	B2 – DIN4102
UL fire rating	UL94	HF-1	HF-2

Total shell thickness: 33 mm. Conform to RITE/2007 (E) requirements

DIMENSIONS

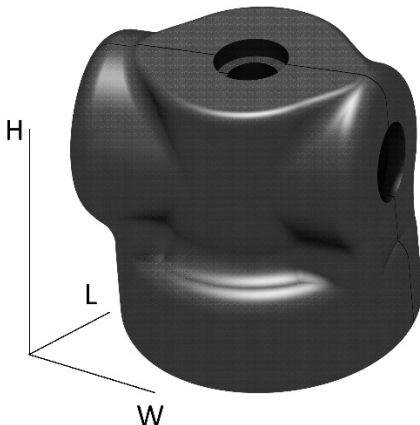

Valve size	L	W	H	Weight [g]
83HPR1 1 ¼" / 83LPR1 1 ½" 83HPR1 1 ½" / 83VLP1 2"	220	220	280	200
83LPR1 2" / 83HPR1 2"	270	270	335	320

Dimensions in mm